

EA 453

EA antipollution non-return valves

System 03

Technical Data Sheet

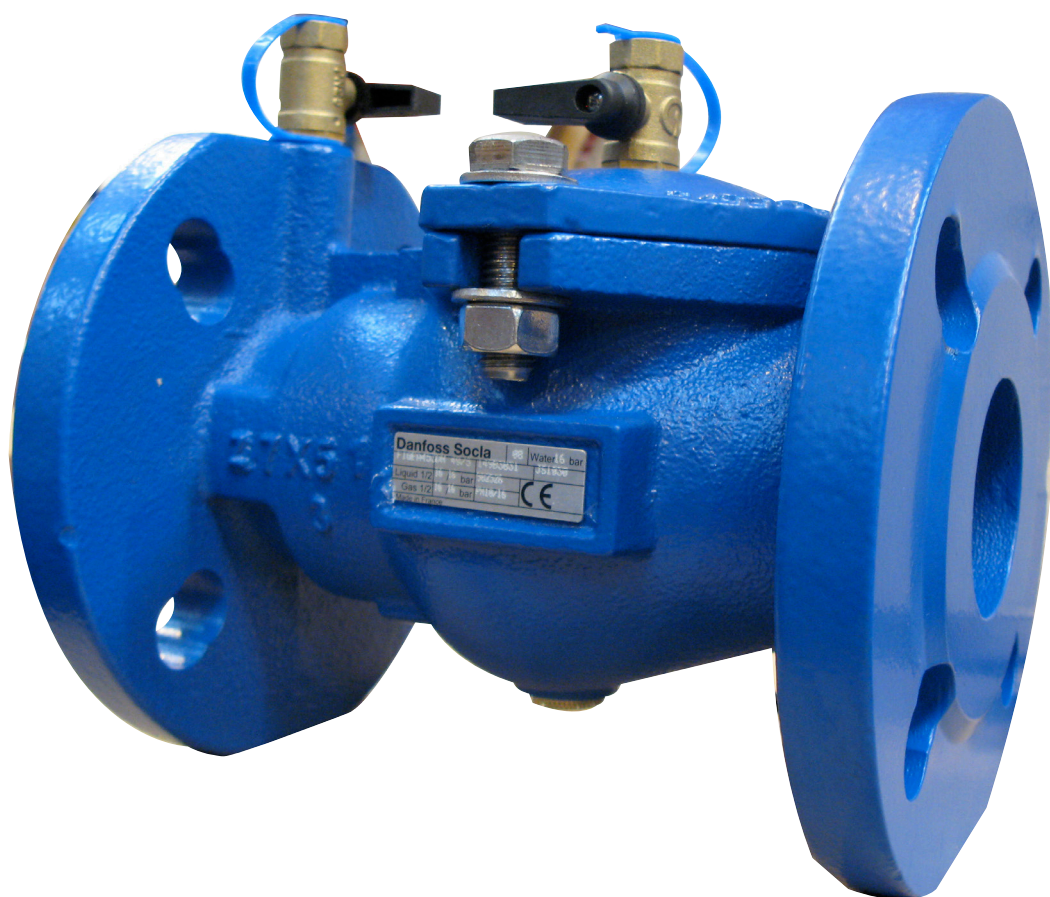

Description

The non-return valve EA 453 is certified to the NF antipollution norms. This non-return valve is designed for the protection of drinking water network against polluted backflow which has no recognized toxic or microbiological risks to human health. It is particularly suitable for mounting after watermeter.

- Approval according to EN 13959
- Operates in any position
- Excellent sealing at high as well as low pressure (NF)
- Inspection cover to check and replace internal parts without dismantling the device
- Interchangeable closing kit without specific tools
- 2 drilled bosses with test cocks 1/2" (except DN 40/50 : 1/4")
- 1 boss with drain plug 1/2" (except DN 40/50 : 1/4")



EA 453

EA antipollution non-return valves - System 03

| DN mm | PFA in bar | PS in bar | | | | Cat. | Ref. | Weight Kg |
|----------|---------------|-----------|----|-----|----|------|-----------------|--------------|
| | | L1 | L2 | G1 | G2 | | | |
| 40/50 | 16 | 16 | 16 | 16 | 16 | I | 149B3831 | 7,65 |
| 60/65 | 16 | 16 | 16 | 15 | 16 | I | 149B3832 | 11,45 |
| 80 | 16 | 16 | 16 | 12 | 16 | I | 149B3833 | 14,36 |
| 100 | 16 | 16 | 16 | 10 | 16 | I | 149B3834 | 20,2 |
| 150 | 16 | 16 | 16 | 0,5 | 16 | I | 149B3836 | 42 |
| 200 | 10 | 10 | 10 | 0,5 | 10 | I | 149B3837 | 65 |
| 250 | 10 | 10 | 10 | 0,5 | 10 | I | 149B3838 | 94 |

Important notice :

The indicated pressure for the different categories of fluids (L1/L2/G1/G2) is under no condition a guarantee of use. Therefore, it is essential to validate the use of products under given operating conditions.

Technical features

| | |
|---|-------------------------|
| Operating temperature | -10 °C at 100 °C |
| Permissible operating pressure (PFA) in water | See table above |
| Maximum permissible pressure (PS) other mediums | See table above |
| Connection | With flange (see table) |
| Mediums | Clear water, gas |

Nomenclature and materials

| N° | Description | Materials | EURO | ANSI |
|----|----------------|--------------------------------|------------------------------|---------------------|
| 1 | Body | Cast iron/Epoxy | EN 1563-EN-GJS-400-15 | ASTM A 536 65-45-12 |
| 2 | Closing system | Brass (Ø50 at 150) | EN12165 CuZn35Pb1.5AlAs-H060 | |
| | | Bronze (Ø200-250) | EN1982 CuSn5Zn5Pb2-C GS | |
| 3 | Seat | Stainless steels | EN10213 GX5CrNi19-10+AT | 304 H (SAE) |
| 4 | Flat seal | EPDM | | |
| 5 | Stem | Brass (Ø50 at 150) | EN12165 CuZn35Pb1.5AlAs-H060 | |
| | | Brass Ø200 | EN12164 CW625N R350mini 4MS | |
| | | Brass Ø250 | EN1982 CuZn39Pb1Al-C GM | |
| 6 | Valve | Brass Ø50 | EN12165 CW602N H070 DIN50930 | |
| | | Brass (Ø65 at 250) | EN 12165-CuZn36Pb2As-H070 | |
| 7 | Plug | Brass | EN12164 CW617N R360 mini 4MS | |
| 8 | O-ring | EPDM | | |
| 9 | Cap | Cast iron/Epoxy | EN 1563-EN-GJS-400-15 | ASTM A 536 65-45-12 |
| 10 | Screw | Stainless steels | EN10088-3 X5CrNi18-10 | AISI 304 |
| 11 | Washer | Stainless steels | EN10088-3 X5CrNi18-10 | AISI 304 |
| 12 | Spring | Stainless steels | EN10270-3 X10CrNi18-8 | AISI 302 |
| 13 | Circlips | Stainless steels | EN10088-3 X5CrNi18-10 | AISI 304 |
| 14 | Cover | PE | Polyethylene | |
| 15 | O-ring | EPDM | | |
| 16 | Lift ring | Steels (Ø150 at 250) | EN 10025-S235JR | |
| 17 | Nut | Stainless steels (Ø150 at 250) | EN10088-3 X5CrNi18-10 | AISI 304 |
| 18 | Washer | Stainless steels (Ø150 at 250) | EN10088-3 X5CrNi18-10 | AISI 304 |

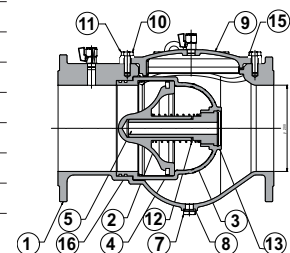
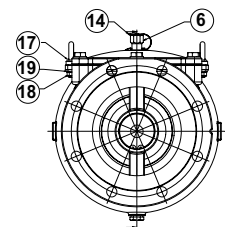

Approvals



International construction Standards :

Flanges connection according to EN 1092-1 and EN 1092-2
Sizing according to EN558-1 series 48 EN 1717
CE conformity directive according to 2014/68/UE
NF antipollution according to NF EN 13959 - EN1717

Application

Housing, water distribution, protection of drinking water networks.

Operation

Direction for use :

- Solid line: Valve completely open
- Dotted line: opening stage of valve

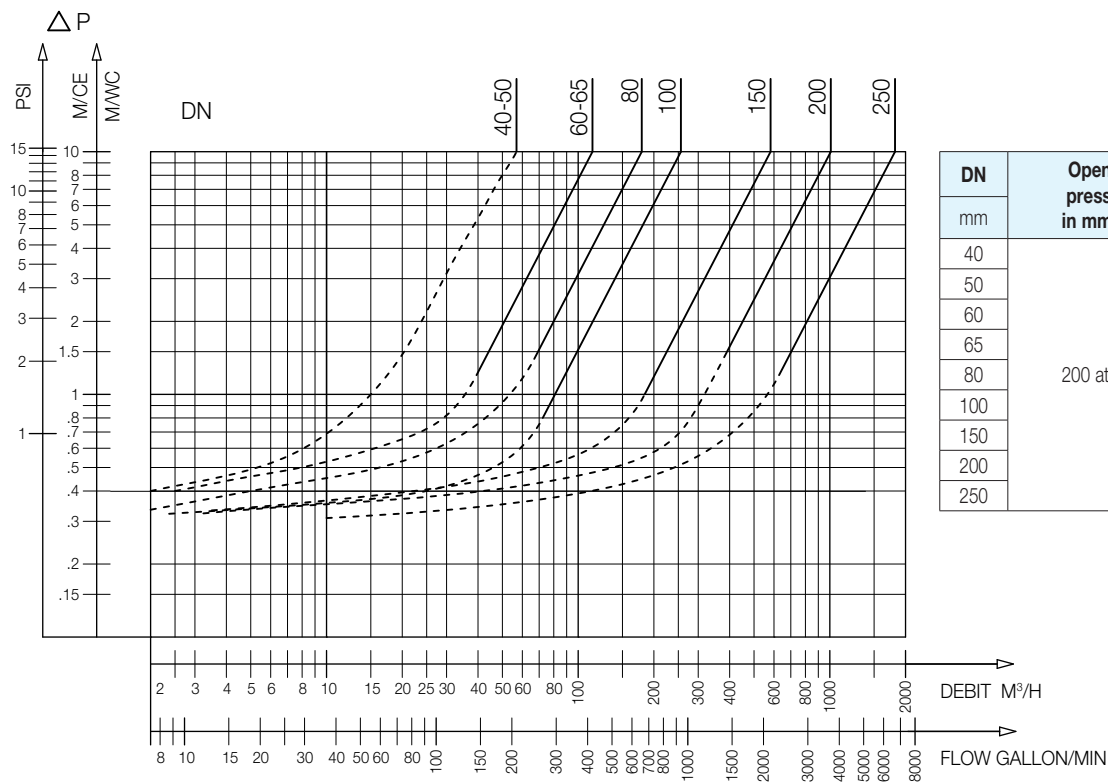

| DN mm | Opening pressure in mm/CE | Kv | ζ |
|----------|---------------------------------|--------|------|
| | | m³/H | |
| 40 | 200 at 400 | 56,9 | 1,85 |
| 50 | | 56,9 | 3,1 |
| 60 | | 114,6 | 1,57 |
| 65 | | 114,6 | 2,2 |
| 80 | | 179,1 | 2,05 |
| 100 | | 256,9 | 2,4 |
| 150 | | 581,7 | 2,4 |
| 200 | | 1009 | 2,5 |
| 250 | | 1816,9 | 1,9 |

EA 453 - Headloss chart

Sizing

| A | B | C | D | E | F |
|-------|-----|-----|-----|-----|-----|
| mm | mm | mm | mm | mm | mm |
| 40/50 | 165 | - | 200 | 113 | 80 |
| 60/65 | 185 | - | 240 | 118 | 93 |
| 80 | 200 | - | 260 | 131 | 98 |
| 100 | 222 | - | 300 | 141 | 115 |
| 150 | 285 | - | 400 | 197 | 144 |
| 200 | 340 | 380 | 500 | 220 | 200 |
| 250 | 400 | 438 | 600 | 256 | 235 |

EA 453

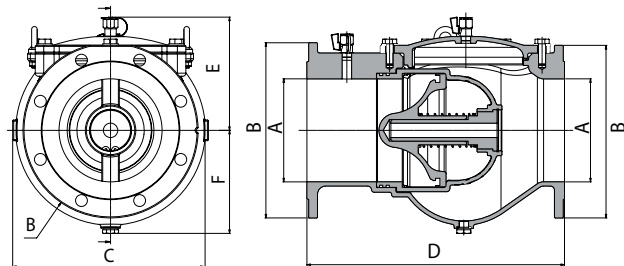

The descriptions and photographs contained in this product specification sheet are supplied by way of information only and are not binding.

Socla reserves the right to carry out any technical and design improvements to its products without prior notice. Warranty : All sales and contracts for sale are expressly conditioned on the buyer's assent to Socla terms and conditions found on its website at www.socla.com. Socla hereby objects to any term, different from or additional to Socla terms, contained in any buyer communication in any form, unless agreed to in a writing signed by an officer of Socla.



A WATTS Brand

Socla sas

365 rue du Lieutenant Putier • 71530 Virey-Le-Grand • France

Tel. +33 03 85 97 42 00 • Fax +33 03 85 97 42 42

contact@wattswater.com • www.socla.com

ISO 9001 version 2015 / ISO 18001